

**+** IQAir

**Atem**<sup>®</sup>

Personal Air Purifier



Quick Start Guide

---

**Read the important safety instructions in the User Guide before using the product.**

---

# Congratulations!

You are on your way to taking control of the air you breathe.

## Power Adaptor and Stand Assembly

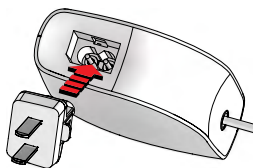

Choose your region's power adaptor and snap into place.

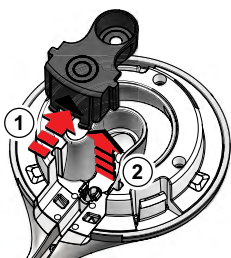

Take stand head and remove connector cover (black part) and set aside.

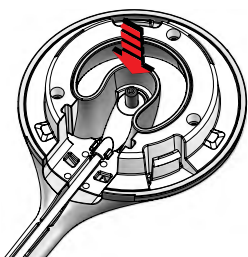

Take the connector end of the power adapter cord and snap into place.

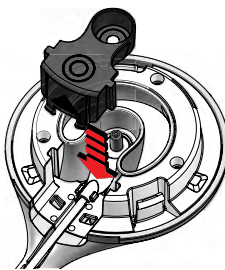

Replace the connector cover.



Press power cord into the channel of the stand head.

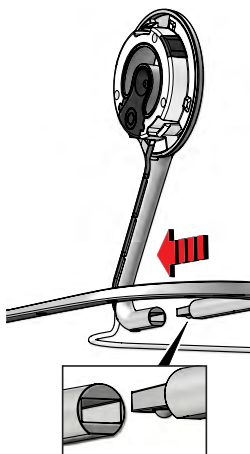

Connect stand head to stand base and stand upright.

## Connect Air Purifier to Stand

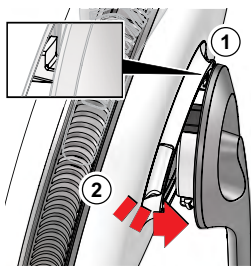
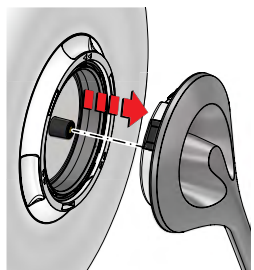

Grasp the air purifier and align with the stand head.

Tilt and hook the air purifier onto the stand head and snap together.

## Turning On and Changing Fan Speed



Air Purifier on Standby.



To change fan speeds tap the Atem logo.

There are three speed settings. Tapping on the Atem logo will change the fan speed in the following order: Standby – Low – Medium – High – Standby.

## Setting Up Your Personal Clean Air Zone

Place the Atem personal air purifier near you on a stable surface such as a desk or table. Point the PureJet diffuser toward your breathing zone.

For best results, place the Atem as close to you as possible.



## IQAir Atem App

To enhance your user experience and to unlock additional features of the IQAir Atem personal air purifier, download and install the IQAir Atem App for Apple or Android. App features and benefits include:

- Smart on/off
- Fan speed settings
- Filter life notifications
- Light and Sound settings

## Bluetooth Pairing

The Atem is automatically in discovery mode and will appear in the Bluetooth section of the App. Tap the Atem name to pair. Enter the Bluetooth code PIN found on the back of the User Guide, the back of the air purifier and on the packaging label.

